

QuikMark™ Versatile Low Line Marker

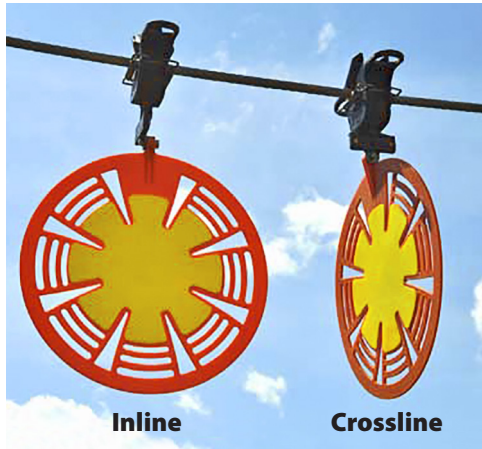

The easy and low cost way to mark low hanging power lines

QuikMark is ideal for construction sites, industrial plants, marinas, or anywhere machinery can strike low hanging distribution lines. The lightweight 10" diameter day-glo orange plastic disk, with yellow center reflector, is highly visible to machine operators. The patented SnapFast spring clamp allows fast and simple installation by hot stick.

QuikMark Applications

Highly visible QuikMark markers effectively prevent costly line damage and outages caused by collisions with tall equipment. These economical markers also work on higher lines at heliports, river crossings, and other high traffic areas.



Opening a SnapFast clamp before installation

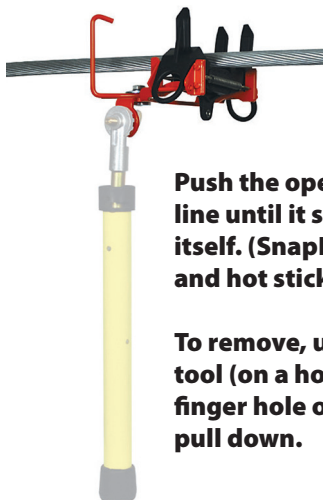

Push the open clamp against the line until it snaps on and locks itself. (SnapFast installation tool and hot stick required.)

To remove, use the installation tool (on a hot stick) to hook a finger hole on the clamp and pull down.

Easy to Install on Hot or Cold Lines

QuikMark has a 10" diameter and weighs 0.6 lbs. It installs in seconds from the ground or a bucket. Our patented and rugged SnapFast mounting clamp prevents line slippage on single or bundled cables. It's also safe to use on OPGW lines. Once in position, the grip is such that the clamp stays in position, even in a Force 8 gale.

Using a hot stick equipped with a SnapFast installation tool, QuikMark can be installed on live power lines up to 115 kV. Simply push the unit against the hot or cold line and the clamp snaps shut. The clamp can be quickly removed using the same tool.

Choose from Inline or Crossline marker, and two sizes of clamp:

Inline QuikMark

10–70 mm (0.39–2.75 in.) P/N #QMD-10-IL-SF10-70
4–16 mm (0.16 to 0.63 in.) P/N #QMD-10-IL-SF4-16

Crossline QuikMark

10–70 mm (0.39–2.75 in.) P/N #QMD-10-CL-SF10-70
4–16 mm (0.16 to 0.63 in.) P/N #QMD-10-CL-SF4-16